

405nm 1mW~2mW SM Coaxial Pigtailed Laser Diode | Built-in Photodiode
405nm 1mW Fiber Coupled LD with Single Mode Fiber | Violet Diode Laser Module with PD
WSLP-405-001m-4-PD
Wavespectrum Laser Group
www.wavespectrum-laser.com

405nm Pigtailed Diode Laser		1mW/SMF		en.wavespectrum-laser.com.cn	
PARAMETER	SYMBOL	VALUE		UNIT	
Reverse Voltage	V_r	2.0		V	
Operating Temperature	T_{op}	0~+70		°C	
Storage Temperature	T_{stg}	-40~+85		°C	
Lead soldering temperature (10 sec.)	T_{is}	260		°C	
Features: <ul style="list-style-type: none"> ● 405nm ● 3um SM Fiber ● Coaxial or B82 Package ● Built-in Photodiode 					
Applications: <ul style="list-style-type: none"> ● Medical Laser Treatment ● Printing ● Others 					
Specifications	WSLP-405-001m-4-PD				
	Min	Type	Max		
Center Wavelength@25°C	405nm±10nm				
Spectral Width (FWHM)	----	2.0nm	----		
Output Power	1mW	----	----		
Fiber Core	3um				
Recommended Operating Temperature	25°C				
Monitor Current	----	0.2mA	----		
PD MAX Reverse Voltage	----	----	30V		
Fiber Connector	FC/SC/SMA905				
Fiber Length	>80cm				
Threshold Current	----	20mA	----		
Operating Current	----	35mA	45mA		
Operating Voltage	----	5.0V	6.0V		
Package Style	Coaxial or B82				
PD	Built-in				

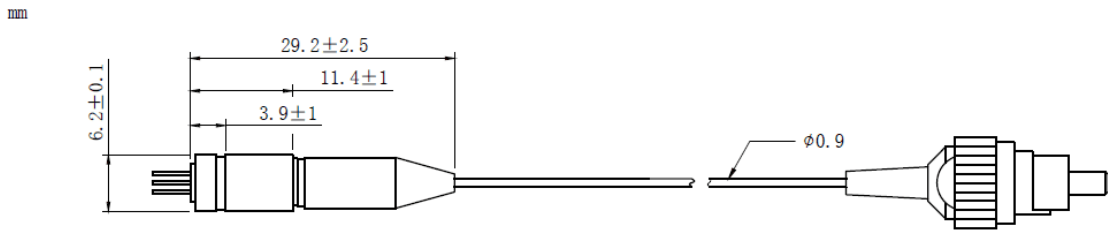

Coaxial Package View: (Part Number: WSLP-405-001m-4-PD)



B82 Package View: (Part Number: WSLP-405-001m-4-B-PD)

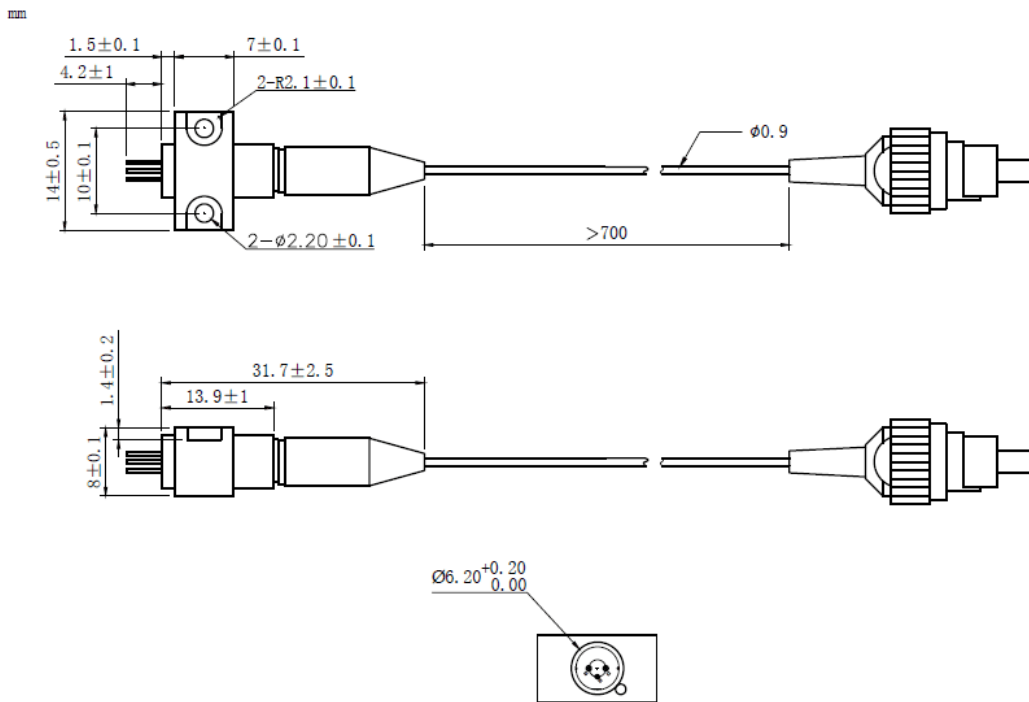

PIN Bottom View:

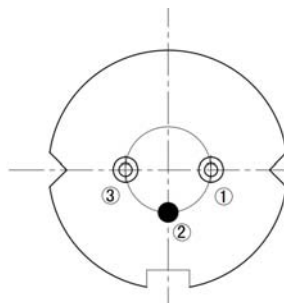

1	LD(+)
2	LD(-)&PD(-)
3	PD(+)



Electrically shorten LD module and store in non-extreme conditions.
Suggest using the constant current power supply.

