

405nm~410nm 30mW SM Coaxial Pigtailed Laser Diode | Built-in Photodiode
405nm 30mW Fiber Coupled LD with Single Mode Fiber | Violet Diode Laser Module with PD
WSLP-405-030m-4-PD
Wavespectrum Laser Group
www.wavespectrum-laser.com

405nm Pigtailed Diode Laser		30mW/SMF		en.wavespectrum-laser.com.cn	
PARAMETER	SYMBOL	VALUE	UNIT		
Reverse Voltage	V_r	2.0	V		
Operating Temperature	T_{op}	-10~+70	°C		
Storage Temperature	T_{stg}	-40~+85	°C		
Lead soldering temperature (10 sec.)	T_{is}	260	°C		
Features: <ul style="list-style-type: none"> ● 405nm ● 3um SM Fiber ● Coaxial or B82 Package ● Built-in Photodiode 					
Applications: <ul style="list-style-type: none"> ● Medical Laser Treatment ● Printing ● Others 					
Specifications	WSLP-405-030m-4-PD				
	Min	Type	Max		
Center Wavelength@25°C	$\pm 5\text{nm}$	405nm	$\pm 10\text{nm}$		
Spectral Width (FWHM)	----	2.0nm	----		
Output Power	----	30mW	----		
Fiber Core	3um				
Recommended Operating Temperature	25°C				
Monitor Current	----	0.3mA	----		
PD MAX Reverse Voltage	----	----	30V		
Fiber Connector	FC/SC/SMA905				
Fiber Length	>80cm				
Threshold Current	----	40mA	75mA		
Operating Current	----	110mA	130mA		
Operating Voltage	----	5.0V	6.0V		
Package Style	Coaxial or B82				
PD	Built-in				

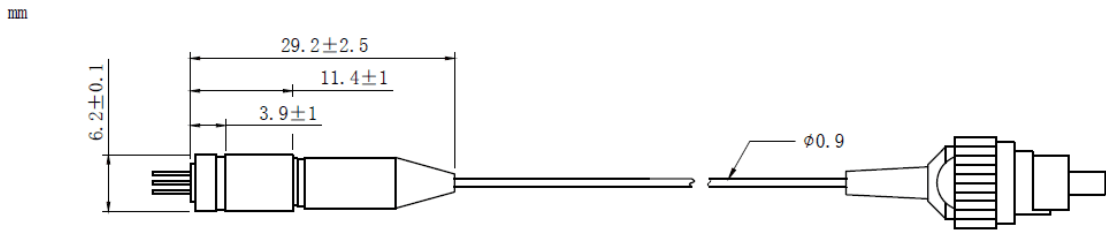
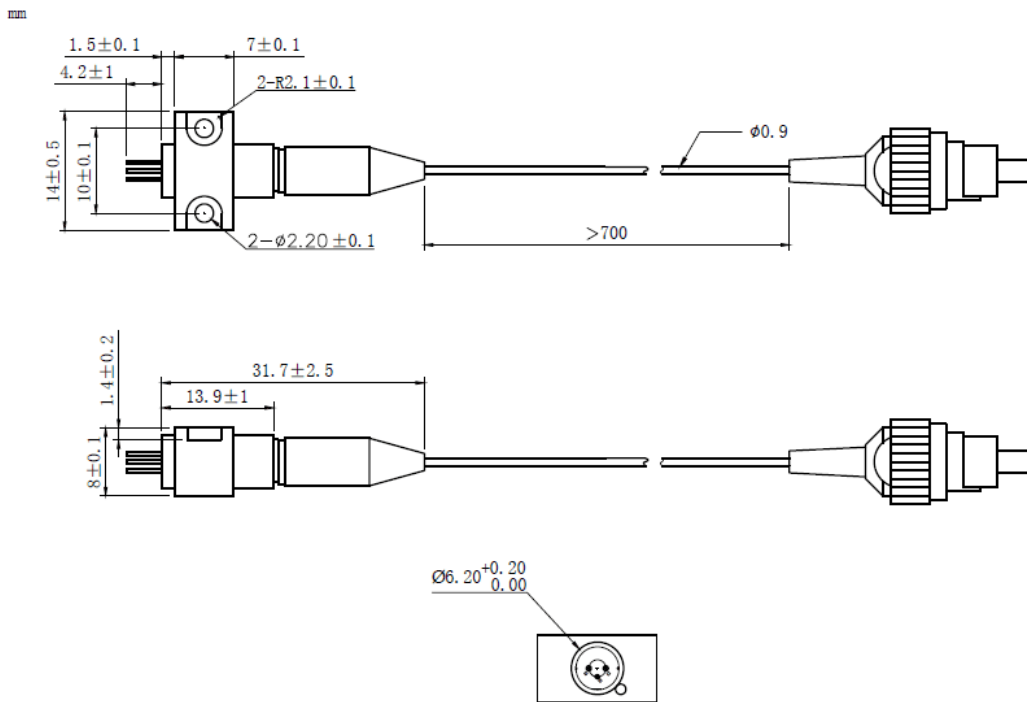
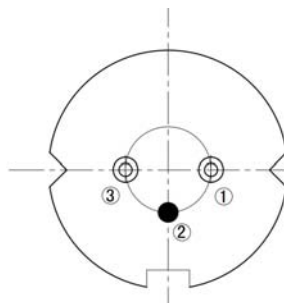

Coaxial Package View: (Part Number: WSLP-405-030m-4-PD)

B82 Package View: (Part Number: WSLP-405-030m-4-B-PD)

PIN Bottom View:

1	LD(-)
2	LD(+)&PD(-)
3	PD(+)



Electrically shorten LD module and store in non-extreme conditions.
Suggest using the constant current power supply.

