

488nm~492nm 30mW Single Mode Coaxial Package Fiber Coupled Laser Diode Module
485nm~488nm~490nm SM Pigtailed LD with 3um Single Mode Fiber (SM Fiber) | Blue LDM

WSLP-488-030m-4

Wavespectrum Laser Group

www.wavespectrum-laser.com
488nm Pigtailed Diode Laser
30mW/SMF
en.wavespectrum-laser.com.cn

PARAMETER	SYMBOL	VALUE	UNIT
Reverse Voltage	V_r	2.0	V
Operating Temperature	T_{op}	-10~+60	°C
Storage Temperature	T_{stg}	-40~+85	°C
Lead soldering temperature (10 sec.)	T_{is}	260	°C
Features: <ul style="list-style-type: none"> ● 488nm Diode Laser ● 3um SM Fiber ● Coaxial or B82 Package ● High Stability 			
Applications: <ul style="list-style-type: none"> ● Medical Laser Treatment ● Biotechnology ● Others 			
Specifications	WSLP-488-030m-4		
	Min	Type	Max
Center Wavelength@25°C	488nm±10nm		
Spectral Width (FWHM)	----	2.0nm	----
Output Power	----	30mW	----
Fiber Type	Single Mode Fiber		
Fiber Core	3um		
Recommend Operating Temperature	25°C		
Fiber Length	> 80cm		
Threshold Current	----	35mA	70mA
Operating Current	----	150mA	170mA
Operating Voltage	----	6.5V	8.0V
Package Style	Coaxial or B82		
Fiber Connector	FC/SC/SMA905		
Photodiode	Without		

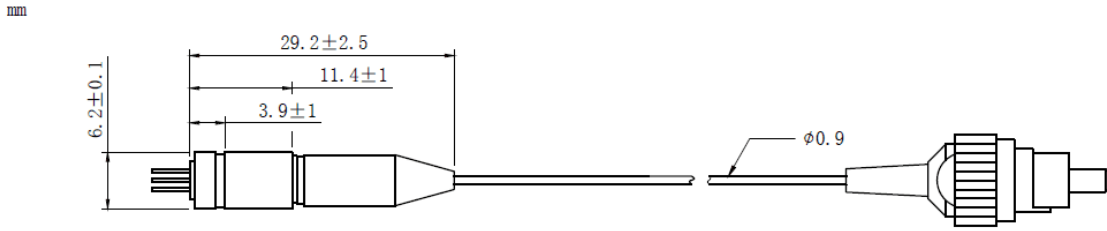
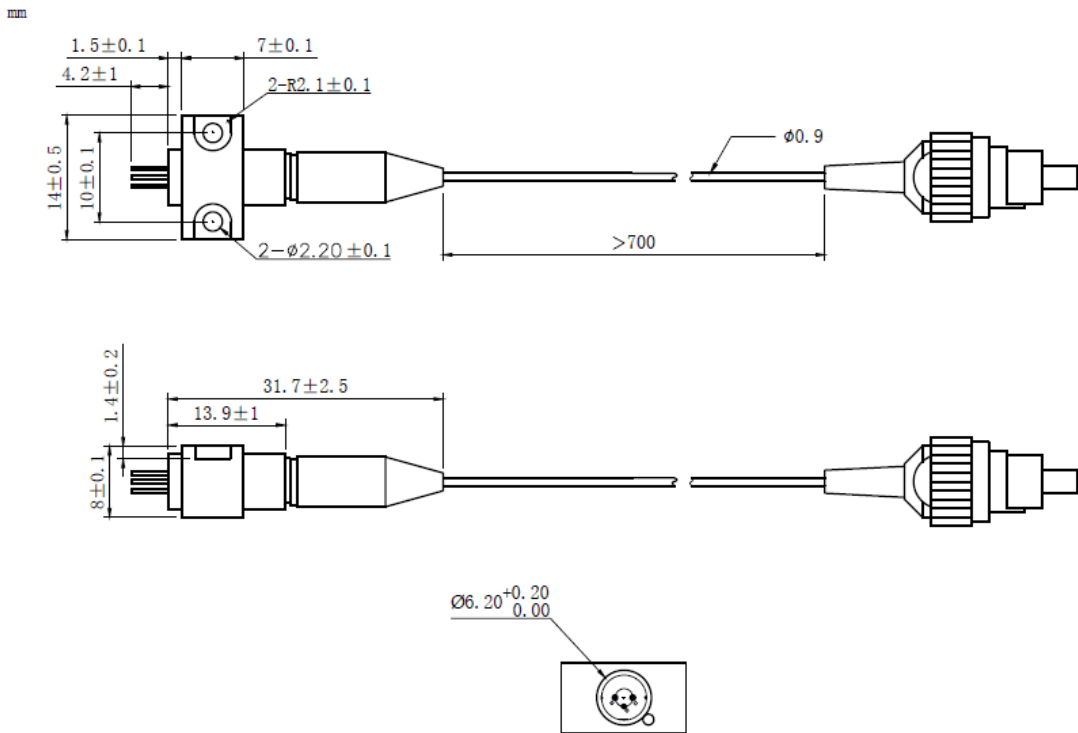
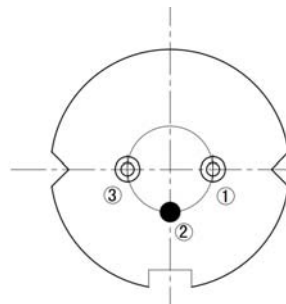

Coaxial Package View: (Part Number: WSLP-488-030m-4)

B82 Package View: (Part Number: WSLP-488-030m-4-B)

PIN Bottom View:

1	LD(+)
2	GND
3	LD(-)



Electrically shorten LD module and store in non-extreme conditions.
Suggest using the constant current power supply.

